

NON-INSULATED FIRE-RATED DOORS - NIFR

FOR WALLS ONLY

The Milcor Non-Insulated Fire-Rated Door may be specified with confidence for service access in drywall, masonry or tile walls where fire ratings are stipulated by code requirements.

Specifications

- **Fire Rated:** Carries both UL and CUL 1 ½ hour, Class B fire rating. Rating is maintained for a 2-hour wall, in stalled where temperature rise is not a factor. This door is designed for wall application only.
- **Material:** 16-gauge frame with 20-gauge door panel
- **Finishes:** Powder Coated Gray or Stainless Steel
- **Hinge:** Continuous Piano Hinge with stainless steel pin
- **Lock:** Self-latching paddle latch and locking system with key operated cylinder lock furnished with two keys and interior release mechanism. Other custom options available upon request.
- **Optional Colors:** Brilliant White, Gold Sand and Jet Black



Drywall Installation Details

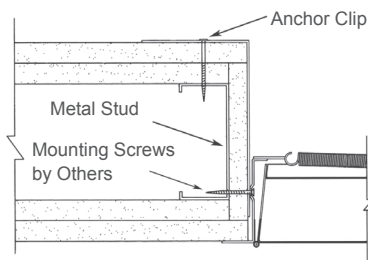

Door Size	Opening	Model No.	No. Cams	Masonry Anchors	Shipping Wt. Lbs.
8" x 8"	8½" x 8½"	3219-008-9	1	4	7
12" x 12"	12½" x 12½"	3219-012-9	1	4	11
14" x 14"	14½" x 14½"	3219-014-9	1	4	13
16" x 16"	16½" x 16½"	3219-016-9	1	4	15
18" x 18"	18½" x 18½"	3219-018-9	1	4	18
24" x 24"	24½" x 24½"	3219-024-9	1	4	28
22" x 30"	22½" x 30½"	3219-023-9	1	4	29
22" x 36"	22½" x 36½"	3219-027-9	1	4	35

Note: Stainless steel not available with Mortise cylinder

Masonry Wall Installation Details

